

# ECD/FID Make-up Gas Replacement Fitting for Agilent GCs Equipped with Make-up Gas

(cat.# 21301)

## Parts List (with replacement part numbers):

1. Fitting with  $\frac{1}{16}$ -inch end connector and flow and manifold connector.
2.  $\frac{1}{4}$ -inch stainless steel nut (cat.# 21902)
3.  $\frac{1}{4}$ -inch Vespel®/graphite ferrule (cat.# 20221)
4.  $\frac{1}{16}$ -inch stainless steel nut (cat.# 21900)
5. 0.4mm ID graphite ferrule (cat.# 20200)
6. Siltek®-treated guide (cat.# 21302)

## Overview

This make-up gas fitting replaces Agilent's ECD/FID make-up gas fitting. It is designed to function with ECDs when the Siltek®-treated guide (item 6) is inserted into the hole at the top of the fitting and firmly pressed into place. The column end should terminate close to the outlet of the Siltek®-treated guide. The fitting also can be used with an FID by removing the Siltek®-treated guide. The tail of the FID jet takes the place of the guide. It is not necessary to press the jet tail into the fitting. A gap is permitted, providing the column end terminates inside the jet tail, close to the jet tip. All column insertion distances remain the same as with the original equipment. Consult your GC operating manual to determine the best make-up gas flow rate for your detector.

## Installation Instructions

1. Reduce the detector temperature to less than 50°C and turn off the make-up gas.
2. Remove the existing make-up gas fitting or any inserts inside the  $\frac{1}{4}$ -inch detector port.
3. Insert the Siltek®-treated guide (item 6) if the fitting will be used with an ECD. (Omit the guide if an FID will be used.) Connect the  $\frac{1}{4}$ -inch make-up gas fitting (item 1) to the detector port, using the  $\frac{1}{4}$ -inch nut and ferrule provided (items 2 & 3).

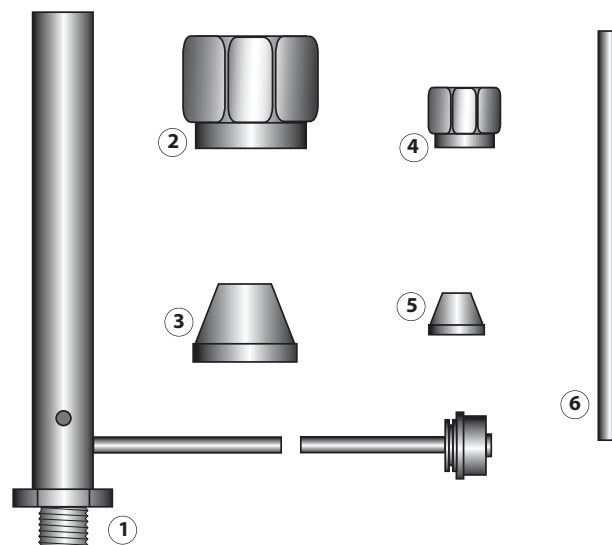

4. Cap the column connection to the detector and leak-check all connections with a Restek Leak Detector (cat.# 22839). Set the make-up gas flow as indicated in the instrument manual after confirming that all fittings are leak-free.
5. Install the column, using the  $\frac{1}{16}$ -inch nut and ferrule provided (items 4 & 5), according to the procedure outlined in your instrument manual and Restek's online column installation guide ([www.restek.com/guide\\_cap.asp](http://www.restek.com/guide_cap.asp)).

Restek trademarks: Restek logo, Siltek

Other trademarks: Vespel (E.I. du Pont de Nemours & Co., Inc.)

**Call Technical Service at 800-356-1688 or 814-353-1300, ext. 4 (or your Restek representative) if you have any questions about this product or any other Restek product.**



**Restek U.S.** • 110 Benner Circle • Bellefonte, PA 16823

phone: 814-353-1300 or 800-356-1688 • fax: 814-353-1309 • [www.restek.com](http://www.restek.com)

**Restek France** • phone: 33 (0)1 60 78 32 10 • fax: 33 (0)1 60 78 70 90 • e-mail: [restek@restekfrance.fr](mailto:restek@restekfrance.fr)

**Restek Ireland** • phone: 44 2890 814576 • fax: 44 2890 814576 • e-mail: [restekeurope@aol.com](mailto:restekeurope@aol.com)

**Thames Restek U.K. LTD** • phone: 44 1494 563377 • fax: 44 1494 564990 • e-mail: [sales@thamesrestek.co.uk](mailto:sales@thamesrestek.co.uk)

**Restek GmbH** • phone: +49 (0) 6172 2797 0 • fax: +49 (0) 6172 2797 77 • e-mail: [info@restekgmbh.de](mailto:info@restekgmbh.de)